

Parts Diagram for DC Power Lift and Tilt Components
Used on Morse 96" Lift Stainless Steel Hydra-Lift Drum Pourers
with 6-digit serial number 315000 to 399999
with 4-digit serial number 0217 to 0222 (MMYY)



**IMPORTANT
NOTE**

4-Digit serial numbers
are simply the month
& year of manufacture

Example: 0802 is
August 2002

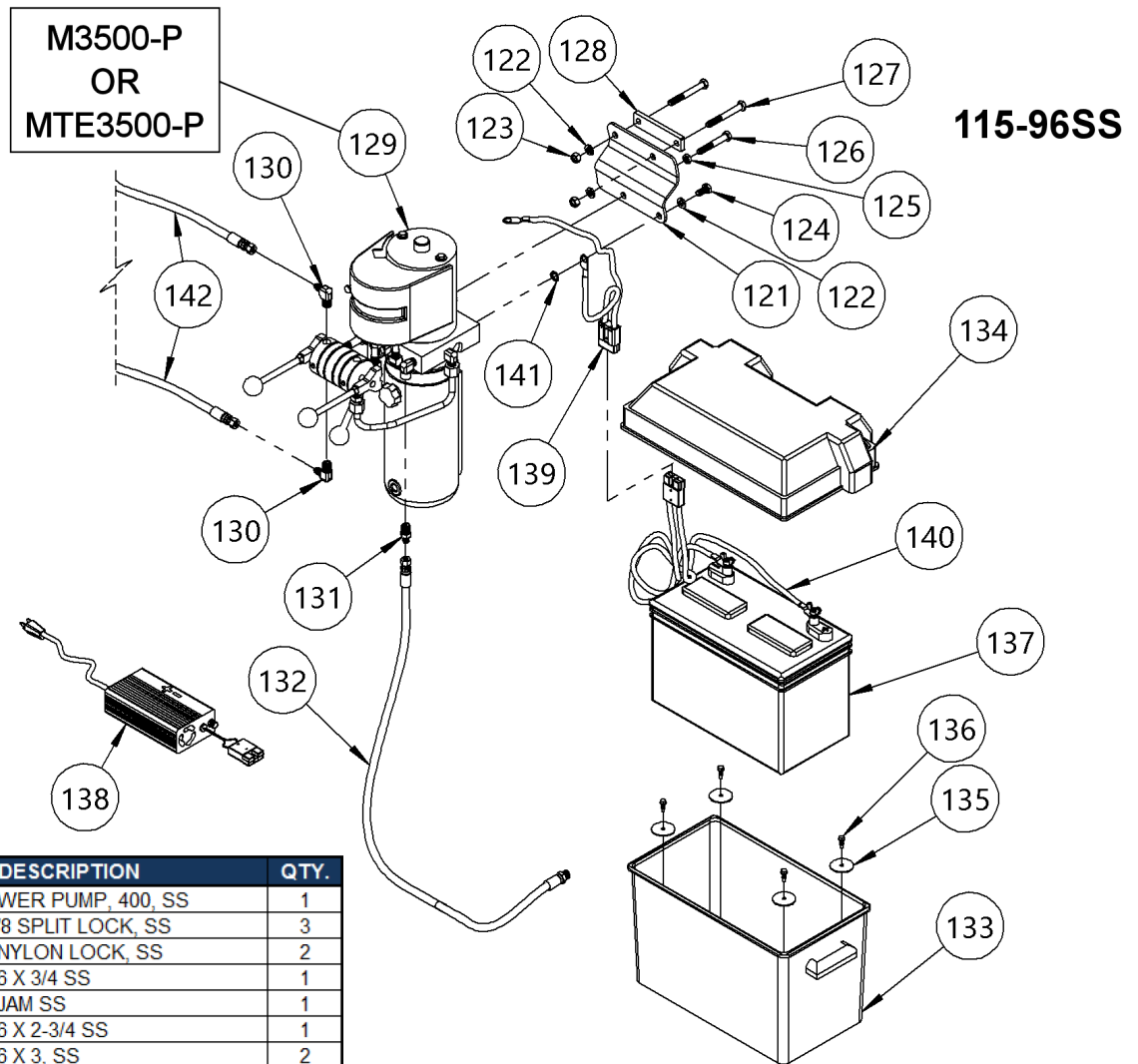

ITEM	PART#	DESCRIPTION	QTY.
121	3643SS-P	MOUNT, POWER PUMP, 400, SS	1
122	1474SS-P	WASHER, 3/8 SPLIT LOCK, SS	3
123	3981SS-P	NUT, 3/8-16 NYLON LOCK, SS	2
124	1657SS-P	HHCS, 3/8-16 X 3/4 SS	1
125	1165SS-P	NUT, 3/8-16 JAM SS	1
126	1315SS-P	HHCS, 3/8-16 X 2-3/4 SS	1
127	1521SS-P	HHCS, 3/8-16 X 3, SS	2
128	5848SS-P	BACK BRACKET, PUMP MOUNT, SS	1
129	M3500-P	(SHOWN) HYD POWER PACK, -115	1
129	MTE3500-P	HYD POWER PACK, -115 MTE	1
130	765-P	HYD FIT, MALE ELBOW, FLARE 400	2
131	345-P	HYD FIT, MALE FLARE, 456, 82	1
132	3689-P	HYD HOSE ASM, 31"	1
133	1729-P	** BOTTOM, BATTERY BOX, 400 BP	1
134	1728-P	** TOP, BATTERY BOX, 400, BP	1
135	4168-P	WASHER, 7/32, 1-1/2 OD, FENDER	4
136	193-P	SCREW, TEK, 12-14 X 3/4 3 PT	4
137	388-P	BATTERY, 12V DC	1
138	391-P	CHARGER 12V 50HZ 60HZ 100-240V	1
139	404-P	HARNESS, PUMP CABLE, 20/20	1
140	403-P	HARNESS, BATTERY CABLE, 20/30	1
141	1739-P	WASHER 3/8 INTERNAL TOOTH LOCK	1
139	1765-P	HYD HOSE ASM, 101", 96 PT	2