

Note: Slide Guide (item # 3A) onto hub of Chain Wheel (item # 1A). Then insert Roll Pin (item # 2A) behind Guide.

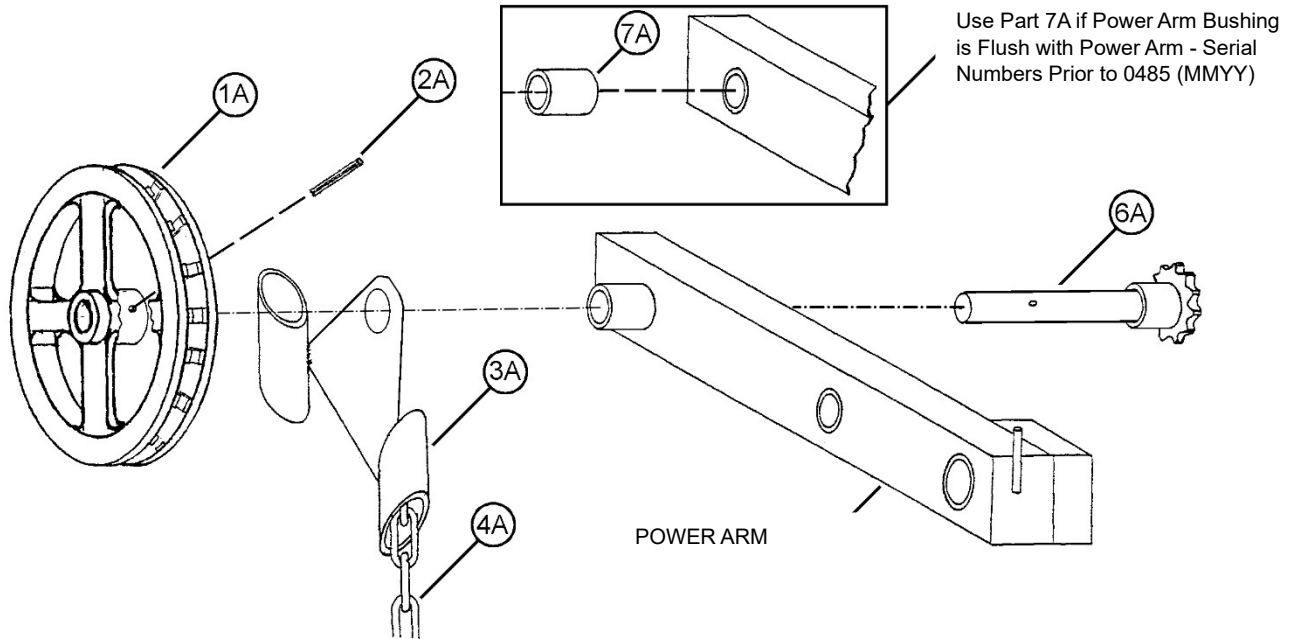

ITEM	QTY	PART	DESCRIPTION
1A	1	1303-P	POCKET CHAIN WHEEL, 3/4 BORE
2A	1	5269-P	ROLL PIN, 3/16 X 1-3/4
3A	1	5245-P	GUIDE, POCKET CHAIN WHEEL
4A	1	3-285-P	CHAIN, PULL, POCKET 20' LENGTH
4A	1	3-185-P	CHAIN, PULL, POCKET 12' LENGTH
4A	1	3-84-P	CHAIN, PULL, POCKET, 9' LENGTH
4A	1	3-72-P	CHAIN, PULL, POCKET, 7' LENGTH
6A	1	5135-P	SHAFT, 12T SPROCKET & SPACER
7A	1	1375-P	BEARING, 3/4" ID X 1" OD X 1"

CHAIN WHEEL KITS

KIT	DESCRIPTION
1318-P	KIT, POCKET CHAIN WHEEL, 20'
1319-P	KIT, POCKET CHAIN WHEEL, 12'
1320-P	KIT, POCKET CHAIN WHEEL, 9'
1321-P	KIT, POCKET CHAIN WHEEL, 7'

* Chain Wheel Kits include items: 1A, 2A, 3A, 6A, 7A and corresponding pull chain (4A).