

MORSE 

285A-BP & 285XBP

SPECIFICATIONS SHEET

POWER-TILT FORKLIFT-KARRIERS
Power-Tilt Forklift-Karriers

Lift, Transport and Pour Drums with Your Forklift

- Add drum handling to your fork truck to raise and control pouring
- Attach to forklift quickly with no tools or truck modification
- No electric or hydraulic connections
- Eliminate backbreaking labor and dangerous, makeshift methods
- Fully invert a drum in less than 15 seconds
- Capacity: 1500 Lb. (680 kg) full drum, 800 Lb. (363 kg) Half-full drum.

Half full rating is an indication of capacity for tilting an unbalanced, bottom-heavy drum. A partially full drum with unbalanced and shifting load is harder to tilt than a full drum.



Model 285A-BP

MORCINCH™ Drum Handling System

Automatically adjusts for 22" to 23.5" (56 to 59.7 cm) diameter drum. Includes a flexible cinch chain cover to help protect drum sidewall. Incorporates alloy cinch chain and durable stress relief weld joints.



Standard Drum Holder with Cinch Chain and Ratchet



Option 5115i-P
Factory Installed Web Strap and Ratchet on New Drum Handler



More on Model 285XBP on page 2



285A-BP & 285XBP

Power-Tilt Forklift-Karriers

SPECIFICATIONS SHEET

Forklift-Karrier Dimensions

Requires 25" between your forks, as fork pocket openings are 25" (63.5 cm) apart.

Each fork pocket opening is 6.5" wide x 2.5" high (16.5 x 6.4 cm)

Fork pockets are 26.5" (67.3 cm) deep
Ships fully assembled.

Domestic ship dimensions:
L42" W40" H 27" (107 x 102 x 69 cm)
Domestic ship weight: 355 Lb. (161 kg)

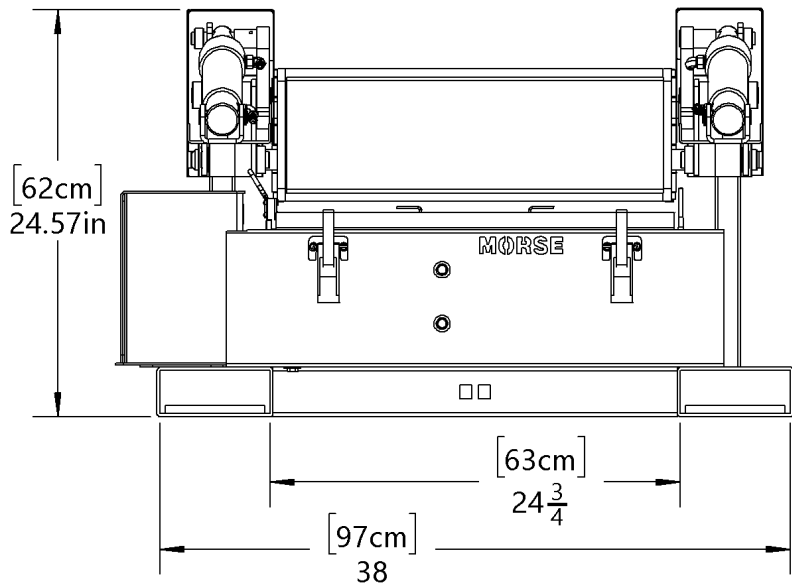
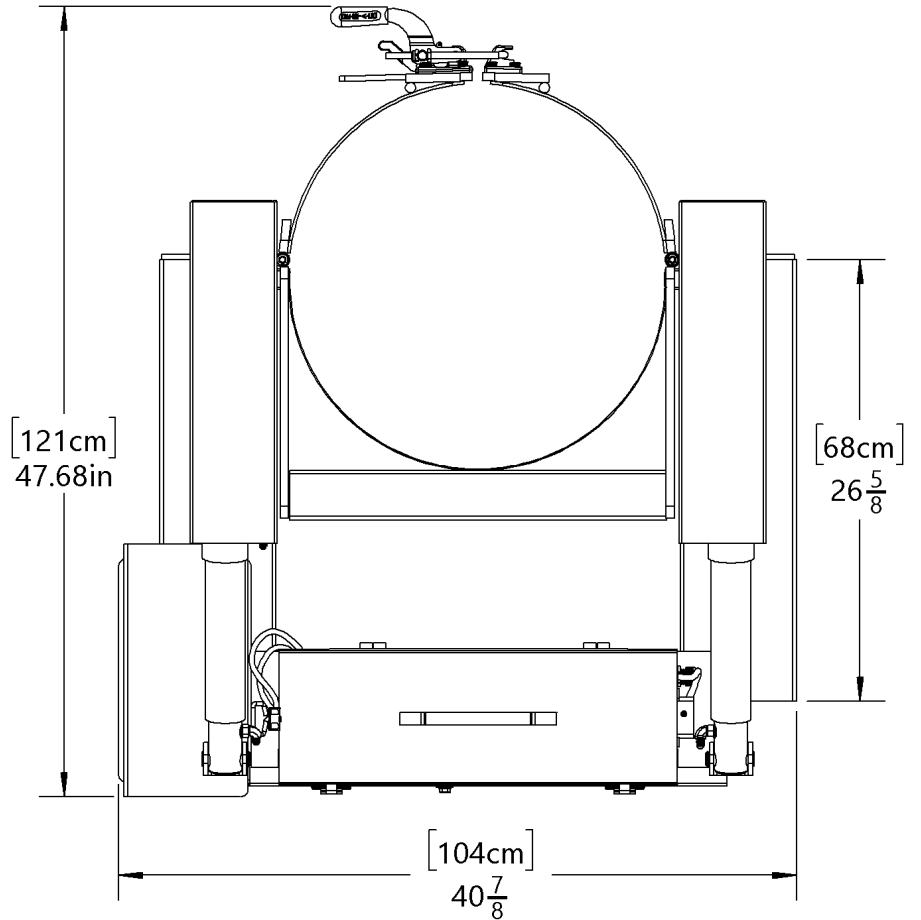



285A-BP & 285XBP

Power-Tilt Forklift-Karriers

SPECIFICATIONS SHEET

MODEL 285A-BP

MODEL	DESCRIPTION	CAPACITY	DRUM DIAMETER
285A-BP	Fortklift-Karrier with battery power tilt control	1500 Lb. (680 kg)	22" to 23.5" (56 to 59.7 cm)

NOTE: 12V Deep Cycle Lead Acid Battery is designed for domestic shipment only. For export shipment, choose the following battery option: Option "NB" No Battery. Customer must obtain battery before use... Exide # 27MDP 12V Deep Cycle Battery or equivalent.

OPTION	DESCRIPTION	CAPACITY	DRUM DIAMETER
4804i-P	Factory Installed Wireless Remote Tilt Control	-	-
5115i-P	Factory Installed Web Strap and Ratchet	1500 Lb. (680 kg)	-
4560B-P	Top Rim Clamp for RIMMED 55-gallon plastic drum	-	22" to 23.5" (56 to 59.7 cm)
4556-P	Bracket Assembly for RIMLESS 55-gallon plastic drum	-	19" to 23.5" (48.3 to 59.7 cm)
55/30 Series	Diameter Adapters (choose correct size for each drum)	-	See Diameter Adapter spec sheet

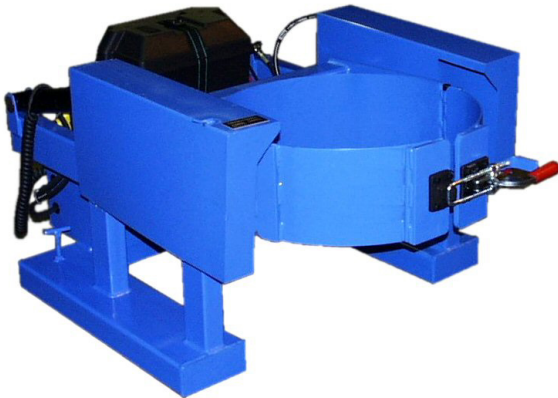

Super-Duty Model 285XBP

Forklift-Karrier with 2500 Lb. (1134 kg) Capacity and Battery Power Tilt

Model 285XBP to lift and pour a drum weighing up to 2500 Lb. (1134 kg) with the convenience of battery powered tilt control.

Extra heavy-duty 3-piece drum holder with toggle clamp closure to secure drum. It can also be ordered with the wireless tilt control factory installed Option # 4804i-P

Domestic ship dimensions: L42" W40" H 27" (107 x 102 x 69 cm)
Domestic ship weight: 500 Lb. (227 kg)

MODEL 285XBP

MODEL #	DESCRIPTION	CAPACITY	DRUM DIAMETER
285XBP	Fortklift-Karrier with battery power tilt control	2500 Lb. (1134 kg)	22.5" (57 cm)
OPTION #	DESCRIPTION		DRUM DIAMETER
4804i-P	Factory Installed Wireless Remote Tilt Control		-
ACCESSORY	DESCRIPTION		DRUM DIAMETER
55/30-19GR	Diameter Adapter for 30-gallon (114 liter) drum		18.5" to 19" 47 to 48.3 cm)



285A-BP & 285XBP

Power-Tilt Forklift-Karriers

SPECIFICATIONS SHEET

Options to Handle Almost Any Drum

Top Rim Clamp

The Top Rim Clamp grips the upper rim of drum to prevent it from slipping length-ways. Use to safely handle a RIMMED 30-gallon to 55-gallon (114 to 210 liter) size plastic or fiber drum.

Kit # 4560B-P - Top Rim Clamp Assembly

To safely handle a plastic drum, you must install either the Bracket Assembly or Top Rim Clamp.

Bracket Assembly

The Bracket Assembly provides a brace at top and bottom of your drum to prevent it from slipping length-ways in the drum holder. It adjusts for 31" to 39" (79 to 99 cm) tall drum. The Bracket Assembly is required to handle a RIMLESS plastic drum. It is also recommended to more securely handle a fiber drum.

Kit # 4556-P - Bracket Assembly

Diameter Adapters

For a smaller diameter drum, Diameter Adapters install easily without tools and are quickly removed. Quickly insert the correct size Diameter Adapter into the drum holder. Simply remove it to return to handling a 55-gallon (210 liter) drum.

Diameter Adapters for 17.5" (44.5 cm) diameter or smaller have brackets at top and bottom of the drum. They adjust for a drum up to 38" (95.5 cm) tall.

Standard Wired Pendant Drum Tilt Control

Model 285A-BP provides 12V battery-powered drum tilt with 2-button control pendant on a 10 foot (305 cm) cord. You control drum pouring with pushbutton ease while in your truck. Fully invert drum to completely empty the contents. Drum tilt may be started, stopped or reversed at any point in the 180° range.

Model 285A-BP Forklift-Karrier has its own battery. No power connection or truck modification is required. Separate charger is included.

Factory Installed Wireless Drum Tilt Control

Safe, simple and reliable wireless machine control. Approximately 300 foot (91 m) operating range featuring 900MHz frequency hopping technology for eliminating interference from other RF sources. Easily switch between direct wire pendant control and wireless remote control. Quick DC power disconnect for locking out the equipment.

Option # 4804i-P - Factory installed Wireless Control on model 285A-BP
Kit # 4804-P - Kit for customer to install Wireless Control on model 285A-BP

