



# 92 SERIES

## SPECIFICATIONS SHEET

### BELOW-HOOK DRUM LIFTERS

Lift and Move a Drum With Your Hoist

## Lift a Rimmed Steel, Plastic or Fiber Drum with Your Crane

- Each Model Works with a Range of Drum Sizes (See chart below)
- Capacity: 1000 Lb. (454 kg)

Self adjusting tong-like action automatically grips various common types of closed drums. Slim-profile grippers allow you to lower a drum into an overpack or salvage drum - place 30's into 55's, or 55's into 85's. Handle steel drum, a rimmed plastic drum, or a lever-lock fiber drum.

Drum lid MUST be on and properly secured. **NOTE:** Rim must be within 1" of the top of drum to be lifted. Do not exceed drum manufacturer's packing limit.

Each Morse below-hook drum handler is load tested at the factory at 125% of rated capacity as per American National Standard ASME B30.20, and a load test certificate is supplied.



Engages Under Top Rim  
Place Drum into Salvage Drum

MODEL	DESCRIPTION	FOR DIAMETER RANGE
92	30 to 85 gallon drum lifter	18" to 26" (45.7 to 66 cm)
92M	Spark Resistant 30 to 85 gallon drum lifter	18" to 26" (45.7 to 66 cm)
92-SS	Stainless Steel 30 to 85 gallon drum lifter	18" to 26" (45.7 to 66 cm)
92-30	30 to 55 gallon drum lifter	15" to 23" (38.1 to 58.4 cm)
92-30SS	Stainless Steel 30 to 55 gallon drum lifter	15" to 23" (38.1 to 58.4 cm)
92-5	5 to 15 gallon pail lifter	11" to 15" (27.9 to 38.1 cm)
92-5M	Spark Resistant 5 to 15 gallon pail lifter	11" to 15" (27.9 to 38.1 cm)



Use with Model 284  
Fork Hook



**Model 92-SS**  
Stainless Steel  
55-Gallon Lifter  
Handle drum with  
18" to 26" (45.7 to 66  
cm) diameter



**Model 92-30**  
30-Gallon Lifter  
Handle drum  
with 15" to 23"  
(38.1 to 58.4 cm)  
diameter



### PAILPRO

**Model 92-5 5-Gallon Pail Lifter**  
**Model 92-5M with Spark Resistant Parts**  
Lift 11" to 15" (27.9 to 38.1 cm)  
diameter pail or can



[morsedrums.com](http://morsedrums.com)



[service@morsedrums.com](mailto:service@morsedrums.com)



(315) 437-8475



103 Kuhn Road, Syracuse, NY, 13208 USA



# 92 SERIES Drum Lifters SPECIFICATIONS SHEET

## DIMENSIONS

### Minimum and Maximum Drum Diameter

Model 92, 92M & 92-SS

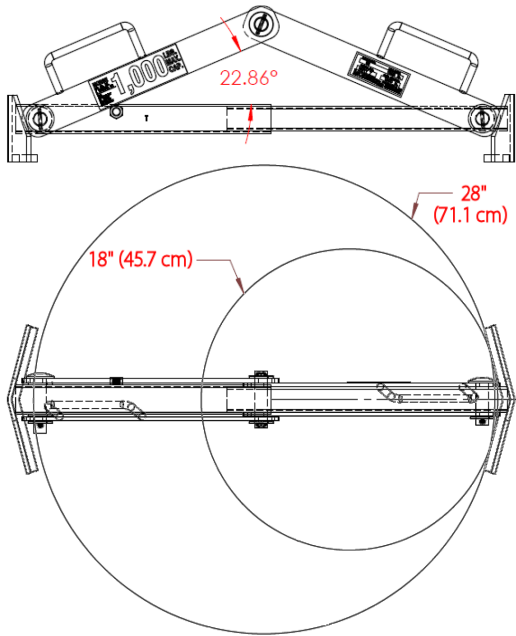

Model 92-30  
& 92-30SS

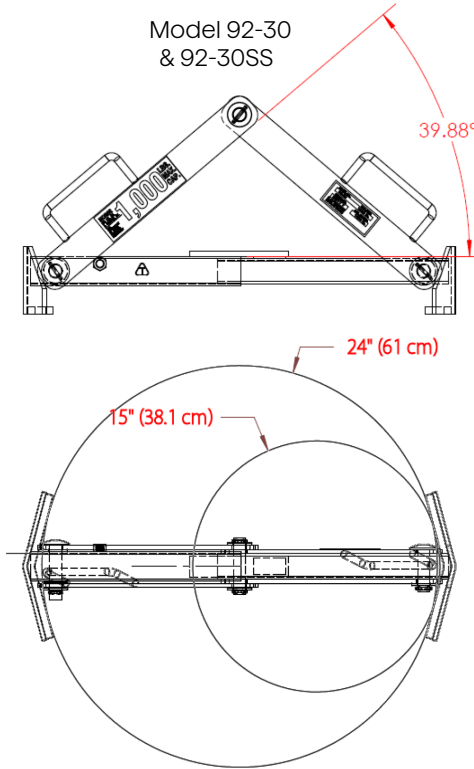

Model 92-5  
& 92-5M

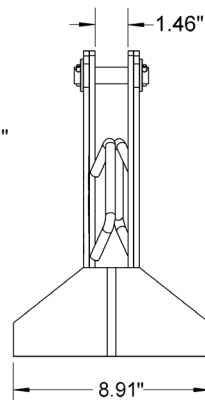
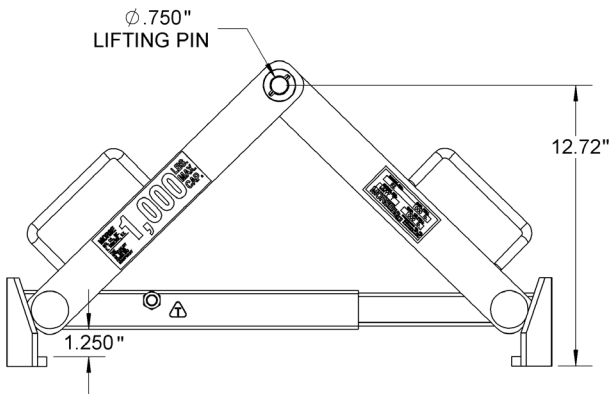
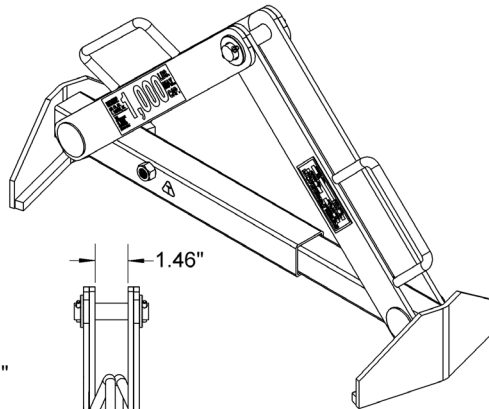
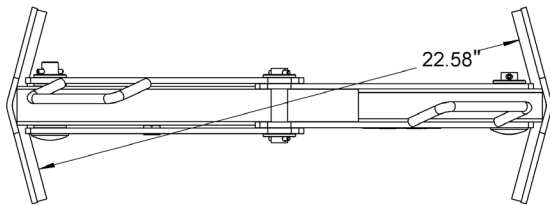
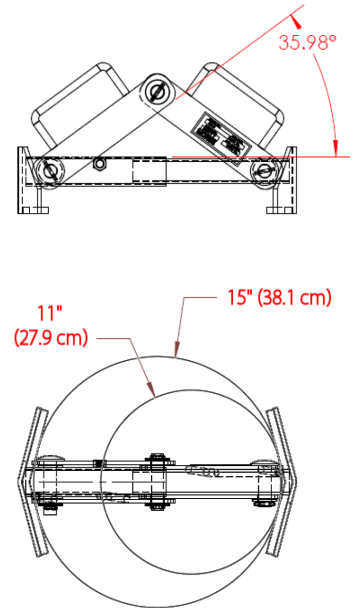

Load an upright drum into a 309 Series Drum Tumbler

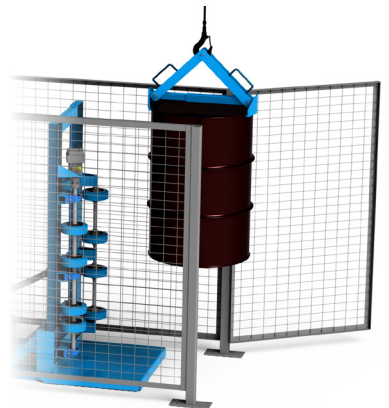

Model 92, 92M or 92-SS Configured for typical 55-gallon (210 liter) steel drum