

**FACTORY INSTALLED X02 Hand Crank Options**

**9" Hand Crank Options**

**FACTORY INSTALLED on NEW Drum Handler**  
with Serial Number 0619 to \_\_\_\_ (MMYY)

- Option X02-185 on NEW model 185A, 185G, 185A-HD or 185G-HD
- Option X02-185M on NEW model 185AM or 185AM-HD
- Option X02-185GR on NEW model 185A-GR
- Option X02-186 on New model 186
- Option X02-285 on NEW model 285A, 285G, 285A-HD or 285G-HD
- Option X02-285M on NEW model 285AM or 285AM-HD
- Option X02-285GR on NEW model 285A-GR
- Option X02-400-72 on NEW 400A-72 Series
- Option X02-400M-72 on NEW 400AM-72 Series
- Option X02-400-96 on NEW 400A-96 Series
- Option X02-400M-96 on NEW 400AM-96 Series
- Option X02-410 on NEW 410 Series

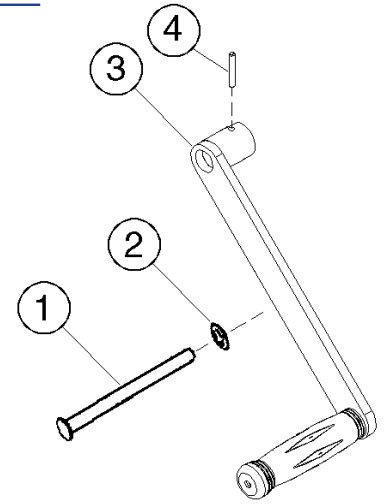
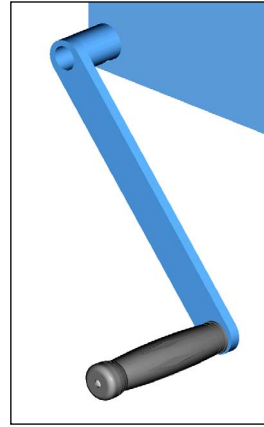

ITEM #	QTY.	PART #	DESCRIPTION
1	1	100-P	STOP PIN, HAND CRANK, 1/2 X 5
2	1	718-P	NUT, PUSH, 1/2"
3	1	5U-P	9" Hand Crank with 3/4" Socket Tube
4	1	64-P	ROLL PIN, 3/16 X 1-1/4

- Option X02-185XGR on NEW model 185XGR is Hand Crank # 1117-P with 5/8" Bore
- Option X02-285XGR on NEW model 285XGR is Hand Crank # 1117-P with 5/8" Bore

**Stainless Steel 9" Hand Crank Options**  
**FACTORY INSTALLED on NEW Drum Handler**  
with Serial Number 0619 to \_\_\_\_ (MMYY)

- Option X02-185HDSS on NEW model 185A-HDSS
- Option X02-285HDSS on NEW model 285A-HDSS
- Option X02-400-72SS on NEW 400A-72SS Series
- Option X02-400-96SS on NEW 400A-96SS Series

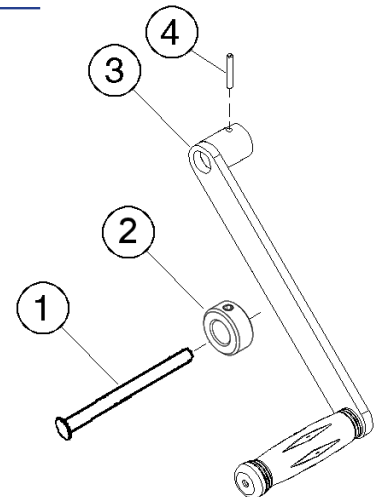
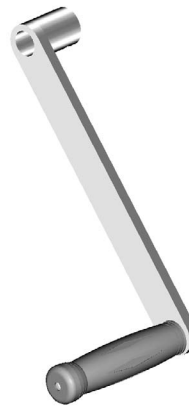

ITEM #	QTY.	PART #	DESCRIPTION
1	1	100SS-P	STOP PIN, HAND CRANK, 1/2 X 5
2	1	1035SS-P	COLLAR, 1/2" ID, SS
3	1	5USS-P	Stainless Steel 9" Hand Crank with 3/4" Socket Tube
3	1	64SS-P	ROLL PIN, 3/16 X 1-1/4, SS



[morsedrum.com](http://morsedrum.com)



[service@morsedrum.com](mailto:service@morsedrum.com)



(315) 437-8475



103 Kuhn Rd.  
Syracuse, NY, 13208 U.S.A.

**FACTORY INSTALLED X03 Hand Wheel Options**

**16" Diameter Hand Wheel Options**  
**FACTORY INSTALLED on NEW Drum Handler**  
with Serial Number 0619 to \_\_\_\_ (MMYY)

- Option X03-185 on NEW model 185A, 185G, 185A-HD or 185G-HD
- Option X03-185M on NEW model 185AM or 185AM-HD
- Option X03-186 on New model 186
- Option X03-285 on NEW model 285A, 285G, 285A-HD or 285G-HD
- Option X03-285M on NEW model 285AM or 285AM-HD
- Option X03-400-60 on NEW 400AM-60 Series
- Option X03-400-72 on NEW 400A-72 Series
- Option X03-400M-72 on NEW 400AM-72 Series
- Option X03-400-96 on NEW 400A-96 Series
- Option X03-400M-96 on NEW 400AM-96 Series
- Option X03-410 on NEW 410 Series

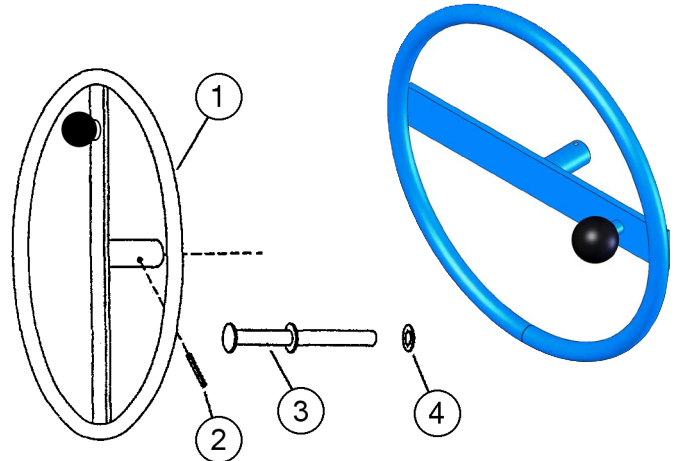

ITEM #	QTY.	PART #	DESCRIPTION
1	1	2685-P	HANDWHEEL 16" 3/4B w/ KNOB
2	1	64-P	ROLL PIN, 3/16 X 1-1/4
3	1	101-P	STOP PIN, HANDWHEEL, 1/2"
4	1	718-P	NUT, PUSH, 1/2"

**Stainless Steel 16" Hand Wheel Options**  
**FACTORY INSTALLED on NEW Drum Handler**  
with Serial Number 0619 to \_\_\_\_ (MMYY)

- Option X03-185HDSS on NEW model 185A-HDSS
- Option X03-285HDSS on NEW model 285A-HDSS
- Option X03-400-72SS on NEW 400A-72SS Series
- Option X03-400-96SS on NEW 400A-96SS Series

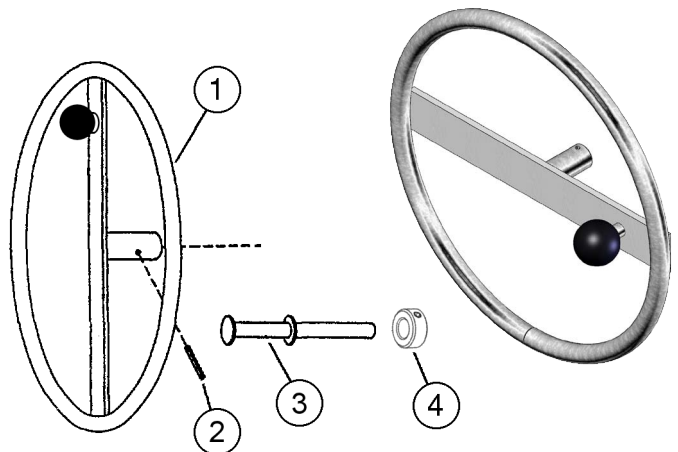

ITEM #	QTY.	PART #	DESCRIPTION
1	1	2685SS-P	HANDWHEEL, 16" SS 3/4B, KNOB
2	1	1035SS-P	COLLAR, 1/2" ID, SS
3	1	101SS-P	STOP PIN, HANDWHEEL, 1/2", SS
4	1	64SS-P	ROLL PIN, 3/16 X 1-1/4, SS

**FACTORY INSTALLED X03 Hand Wheel Options**

**10" Diameter Hand Wheel Options**  
**FACTORY INSTALLED on NEW Drum Handler**  
 with Serial Number 0619 to \_\_\_\_ (MMYY)

**10" Diameter Hand Wheel with 3/4" Bore**

- Option X03-185GR on NEW model 185A-GR
- Option X03-285GR on NEW model 285A-GR

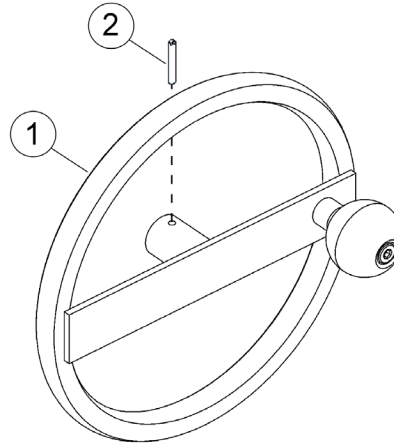

ITEM #	QTY.	PART #	DESCRIPTION
1	1	4385A-P	HANDWHEEL, 10" 3/4" BORE
2	1	64-P	ROLL PIN, 3/16 X 1-1/4

**10" Diameter Hand Wheel with 5/8" Bore**

- Option X03-185XGR on NEW model 185XGR
- Option X03-185XMGR on NEW model 185XMGR
- Option X03-285XGR on NEW model 285XGR
- Option X03-285XMGR on NEW model 285XMGR

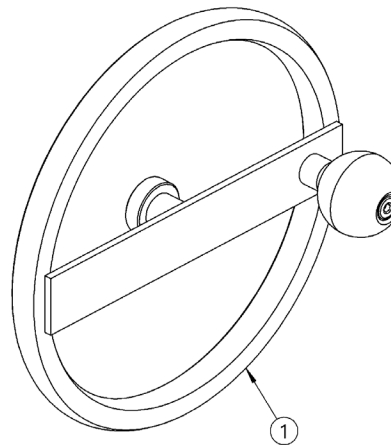

ITEM #	QTY.	PART #	DESCRIPTION
1	1	6478-P	HANDWHEEL, 10" 5/8" BORE, XGR