

#### Parts List and Diagram for Model 160-WP-SS

#### Stainless Steel 4-Wheel Drum Truck with Pneumatic Wheels

Serial Number 1215 to \_\_\_\_\_

For replacement parts, please contact your Morse dealer.

When ordering parts, please specify:

- Part number and description
- Model number

#### IMPORTANT NOTE

4-Digit serial numbers are simply the month & year of manufacture

Example: 0802 is August 2002

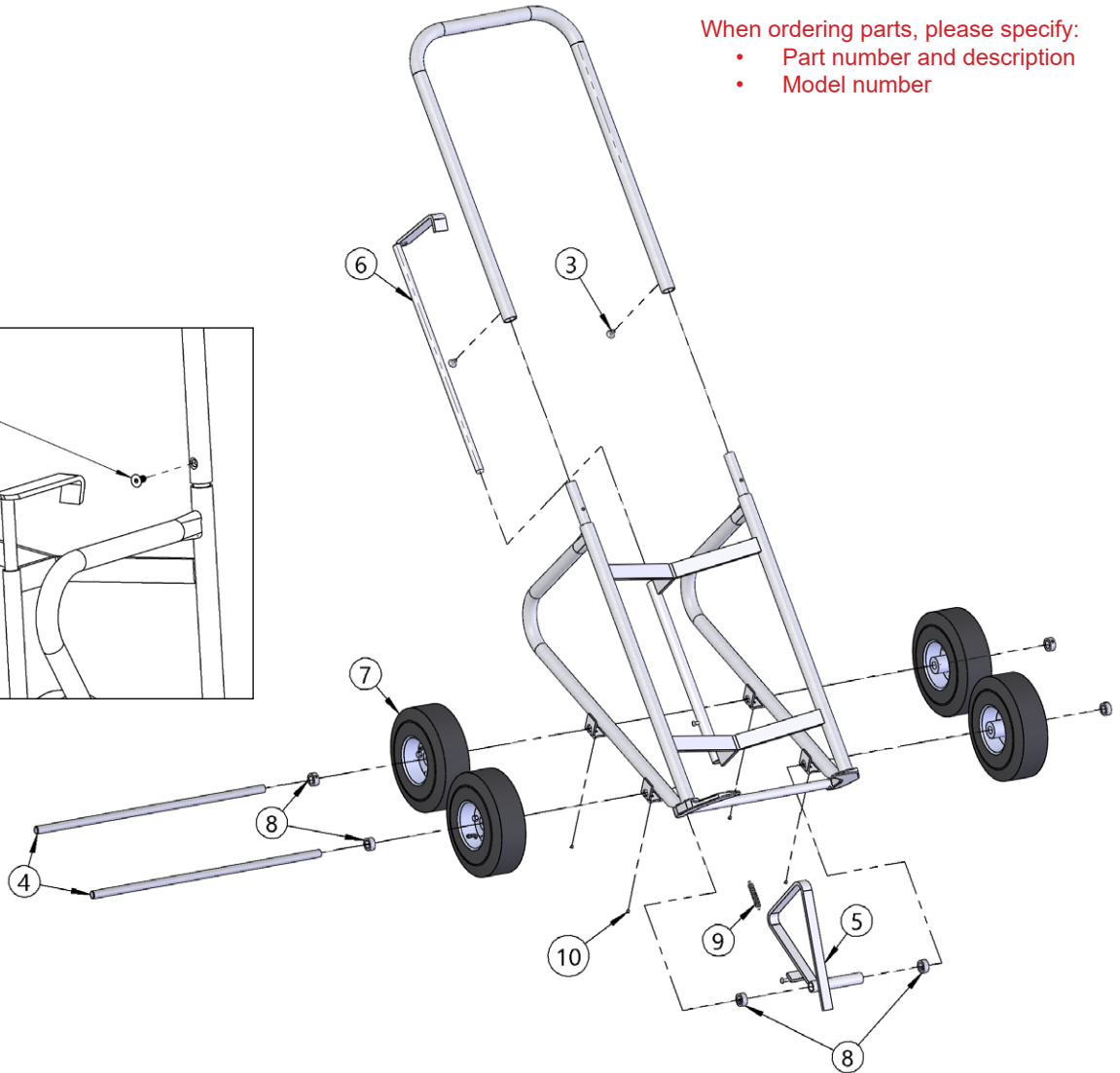
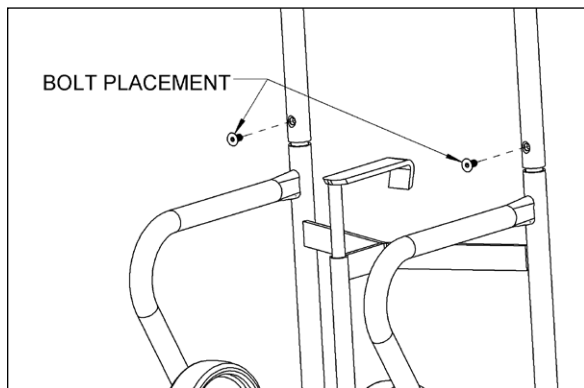

**WARNING:** This product can expose you to chemicals including barium sulfate, cobalt, titanium dioxide, and 2-methylimidazole, which are known to the State of California to cause cancer, and bisphenol-A, which is known to the State of California to cause birth defects or other reproductive harm.

For more information go to [www.P65Warnings.ca.gov](http://www.P65Warnings.ca.gov)

| ITEM NO. | PART NUMBER | DESCRIPTION                   | QTY. |
|----------|-------------|-------------------------------|------|
| 3        | 4685SS-P    | SHCS, 3/8-16 X 3/4 FH, SS     | 2    |
| 4        | 1381SS-P    | AXLE, 25.5", 160-WP-SS        | 2    |
| 5        | 2752-P      | STAND WELD, 160-SS            | 1    |
| 6        | 5941SS-P    | HOOK WELD, 160-SS             | 1    |
| 7        | 1379-P      | WHEEL, PNEUMATIC 10", 160-WP  | 4    |
| 8        | 15SS-P      | COLLAR, 3/4" ID, SS           | 6    |
| 9        | 1114SS-P    | SPRING, EXTENSION, SS, 160-SS | 1    |
| 10       | 1000SS-P    | SET SCREW, 1/4-20 X 1/4, SS   | 4    |