

Operator's Manual for Morse Rim Clamp Assembly - Part # 3540-P
Serial Number 0402 to ____ (MMYY)

A. INSTALLATION INSTRUCTIONS

1. Insert rim clamp (item 10) into drum holder socket.
2. Line up lower hole of rim clamp with top hole of drum holder socket
3. Bolt in place using item 8 and 9

B. OPERATING INSTRUCTIONS

TO SECURE DRUM:

1. Turn hand wheel (item 5) counter clockwise to open top jaw (item 6).
2. Position drum holder assembly with bottom jaw of rim clamp directly under top rim of drum.
3. Turn hand wheel clockwise until top jaw is pressing tightly against top of drum (see Figure 1).
4. Secure drum with chain and ratchet mechanism. Drum is now ready to be lifted and tilted.

TO RELEASE DRUM:

1. Lower drum to floor in an upright position.
2. Release chain from ratchet mechanism by applying pressure to ratchet handle in a clockwise direction with one hand and opening pawl to free ratchet with other hand. Remove chain link from ratchet.
3. Open rim clamp by turning hand wheel counter clockwise.

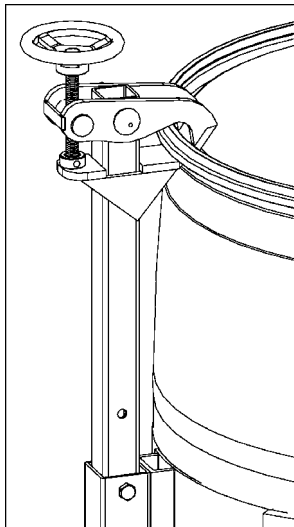
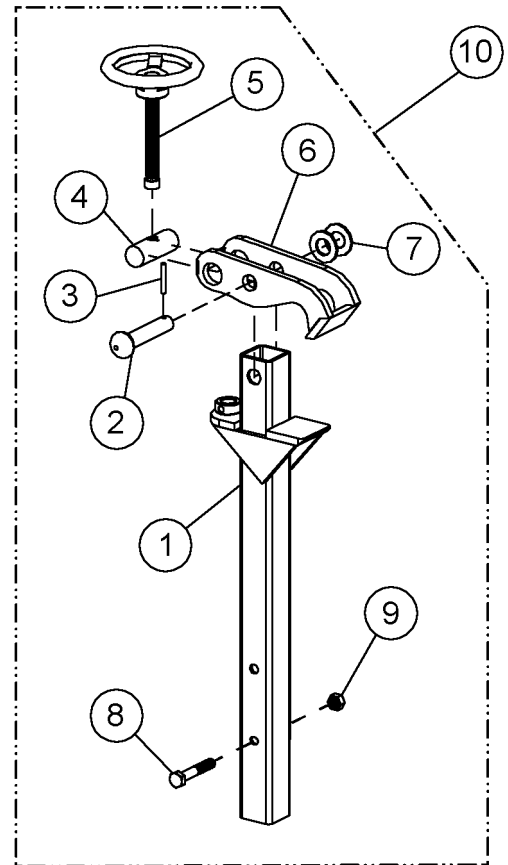

Figure 1

Plastic drum being lifted with
part number 3540-P Rim Clamp
Assembly installed.

ITEM	QTY	PART #	DESCRIPTION
1	1	3241-P	RIM CLAMP WELD, 185R
2	1	138-P	CLEVIS PIN 5/8 X 3"
3	1	64-P	ROLL PIN, 3/16 X 1-1/4
4	1	3510-P	THREADED BARREL, RIM CLAMP
5	1	3616-P	HANDWHEEL ASM, 4", 185R
6	1	3239-P	TOP JAW, RIM CLAMP, WELD
7	2	17-P	WASHER, 5/8 SAE FL 1-5/16 O
8	1	1315-P	HHCS, 3/8-16 X 2-3/4 GR2
9	1	1169-P	NUT, 3/8-16 REV HEX LOCK
10	1	3540-P	RIM CLAMP ASM, SCREW TYPE 185R