

MORCINCH Web Strap and Ratchet Drum Holder Assembly (part # 5000W-P)

The drum holder with Web Strap and Ratchet is designed to handle a 55-gallon steel drum.

When used for a plastic drum or a fiber drum, it requires a [Top Rim Clamp](#) or [Bracket Assembly](#).

Note: The Web Strap and Ratchet is not for use with spark resistant models.

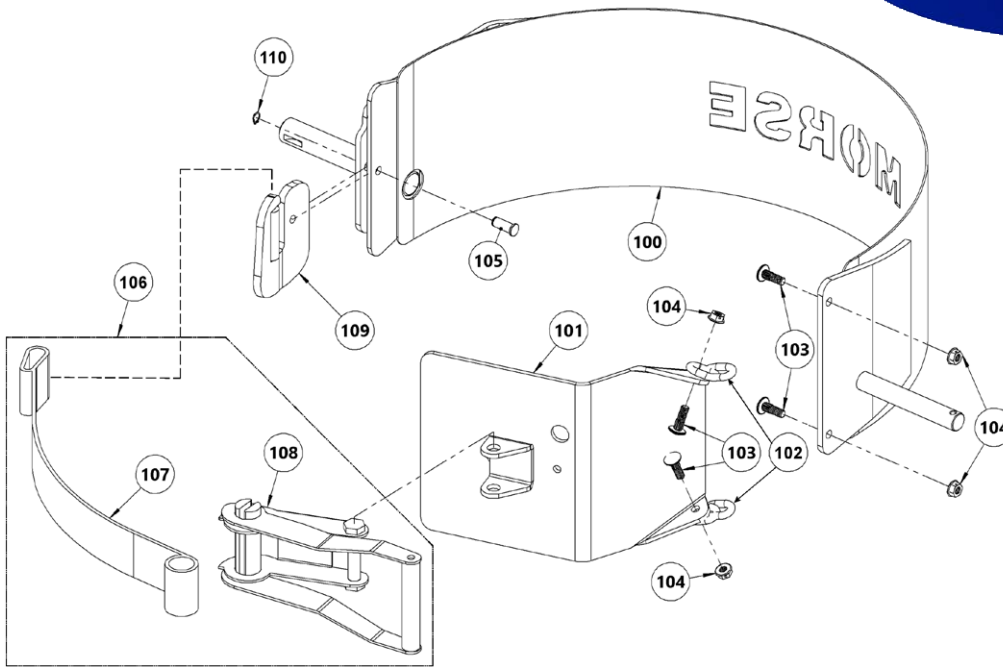
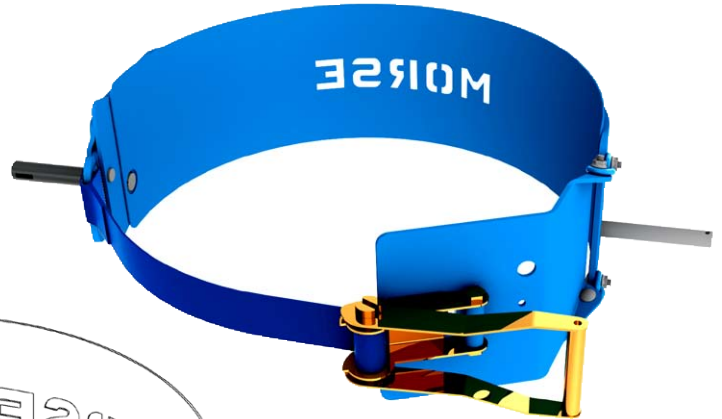

ITEM	QTY.	PART #	DESCRIPTION
100	1	4210-P	SADDLE WELD, MOR
101*	1	6021-P	RATCHET PLATE WELD, WEB STRAP
102*	2	5019-P	CHAIN, HINGE, 9/32 ALLOY 2 LK
103*	4	4177-P	BOLT, 5/16-18 X 1 CARRIAGE RIB
104*	4	4178-P	NUT, 5/16-18 FLANGE LOCK, MOR
105*	1	4172SP-P	PIN, S.P., CINCH CHAIN, 5000-P

ITEM	QTY.	PART #	DESCRIPTION
106*	1	4449-P	WEB TIE DOWN ASM, 2" X 3'
107	1	5497-P	WEB STRAP ONLY, 4449-P
108	1	5498-P	RATCHET ONLY, 4449-P
109	1	5327W-P	CLEVIS WELD, WEB STRAP, 309
110*	1	4744-P	SNAP RING, EXTERNAL, 3/8"
* Recommended spare parts.			

Maintenance

1. Periodic inspection for the general condition of structural and mechanical components is imperative for safe and efficient operation.
2. Periodically inspect all moving parts, framework, and contact areas for signs of wear, fatigue, or loosening. Tighten, adjust, or replace parts as necessary to prevent failure and maintain proper function.
3. Worn or damaged parts must be properly replaced with correct, genuine Morse parts.
4. The polyester web strap should be removed from service and replaced if any of the following are visible:
 - Acid or caustic burns
 - Melting or charring of any part of the strap
 - Holes, tears, cuts, snags or embedded articles
 - Broken or worn stitching in load bearing splices
 - Excessive abrasive wear