

**Parts List and Diagram for Morse Kit # 5017KIT-P**

This kit is required to replace the 3/16 alloy cinch chain (part # 180-P) and ratchet (part # 165-P) on Morse drum holders. The 3/16 chain is no longer available and has been replaced by a 9/32 alloy chain. The ratchet (part # 165-P) needs to be replaced in order to accommodate the larger diameter chain.

Replacement ratchet and chain **MUST** be installed together. Discard existing chain and ratchet.

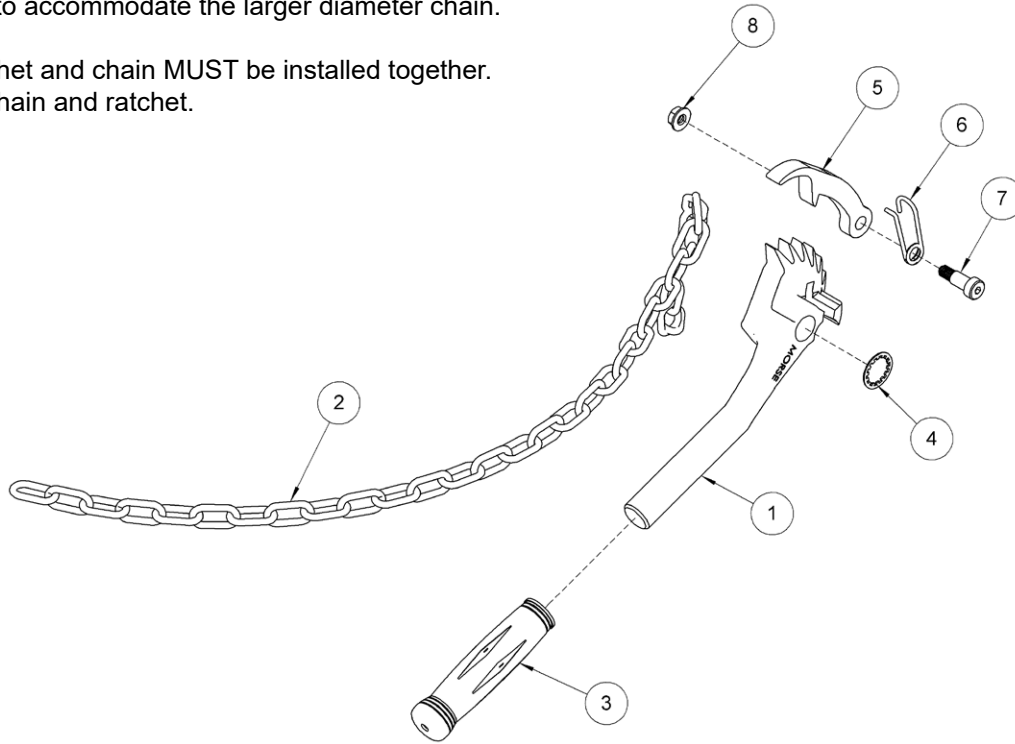

ITEM	QTY.	PART #	DESCRIPTION
1	1	-	RATCHET, SADDLE, 9/32 CHAIN (NOT SOLD SEPARATELY)
2	1	5017-P	CHAIN, CINCH, 9/32, 38 LINK
3	1	136-P	GRIP, HANDLE 7/8" X 4-3/4"
4	1	710-P	RETAINER, RATCHET PUSH NUT 3/4
5	1	168-P	PAWL, WITH DRILLED HOLE
6	1	169-P	SPRING, PAWL
7	1	170-P	SCREW, 3/8 DIA X 5/8 SHOULDER
8 *	1	1634-P	5/16 - 18 WHIZ - LOCK NUT

\* Used on MORcinch saddles only, starting with serial number 0309 (March 2009)